

... (« », . ,)

· ,

,

·

,

·

:

,

1.

[1],

,

,

·

,

[2, 3]

,

,

·

[4]

,

-

,

,

:

• ,

()

;
;
;

2.

[4],

,

:

,

,

[2],

,

()

: 6 11.

. 1.

,

,

,

.

,

,

,

, [4],

,

,

,

-

[4].

(. ,

)

« »:

,

.

(,)

-

.

,

,

,

,

0,75

(. 4).



$$, \quad (\quad)$$

9

, ,

(. 4).

1.

43

D			
	-	-	,
1	715h14(-2)	713,50	715 ^{h14} / _{1,428 (-0,6)}
2	665 h8(-0,125)	664,89	665 ^{h8} / _{1,428(-0,0375)}
3	720 h8(-0,125)	719,90	720 ^{h8} / _{1,428(-0,0375)}
4	815 h14(-2,3)	813,94	815 ^{h14} / _{1,428(-0,61)}
5	835,47	835,46	835,47
6	955h8(-0,14)	954,89	955 ^{h8} / _{1,428(-0,042)}
7	1600 ⁺²	1490,6	1600 ⁺²
8	955h8(-0,14)	954,90	955 ^{h8} / _{1,428(-0,042)}
9	835,47	835,47	835,47
10	399h9(-0,14)	398,92	399 ^{h9} / _{1,428(-0,042)}
11	335 h9(-0,14)	334,90	335 ^{h9} / _{1,428(-0,042)}
12	292 h9(-0,13)	291,91	292 ^{h9} / _{1,428(-0,039)}
13	330 h14(-1,4)	328,87	330 ^{h14} / _{1,428(-0,042)}

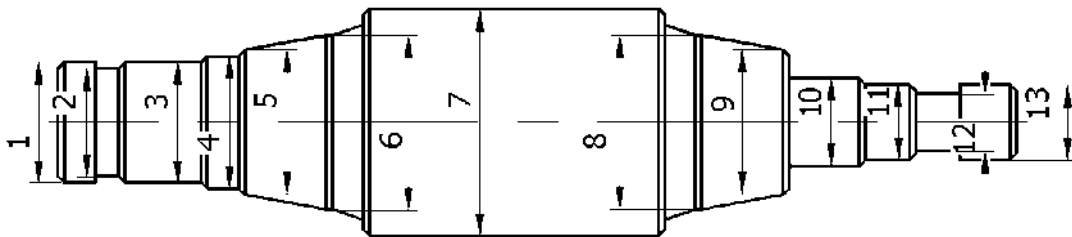

. 2.

, , ,
 , ,
 .

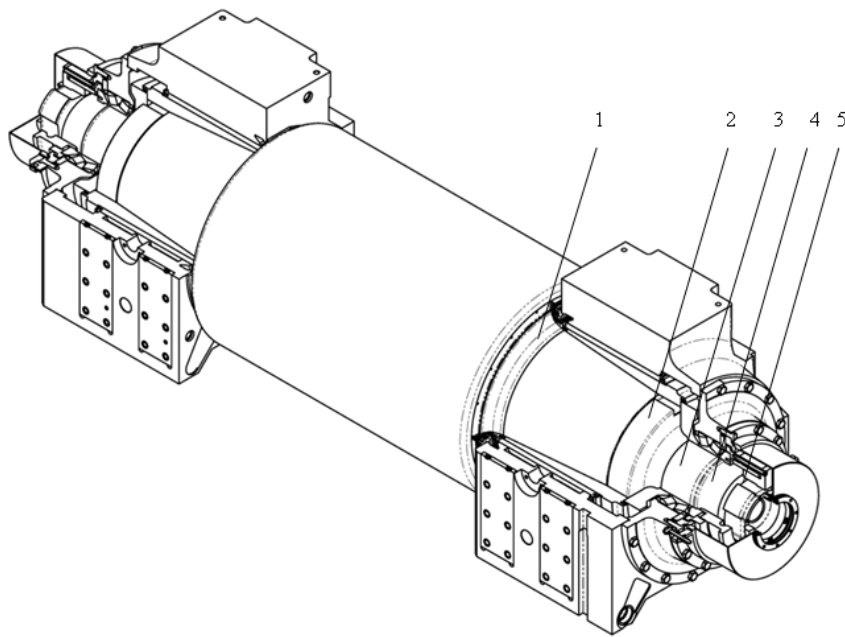

. 3.

1, 2 –

()

; 3 -

; 4 -

; 5 -

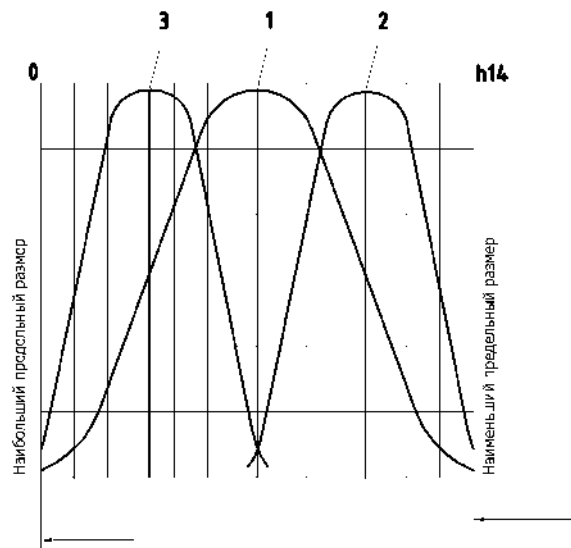

.4.

()

(1);

(2)

(3)

3.

()

,

0,75

.

()

,

,

.

,

30-40

.

(. .),

h8 ...h14

292 ...1650

1,428

.
(

20)

,

6-11

,

.

.

,

(. 2)

.

,

,

,

(. 4).

,

()

.

: 1.

. .

//

«

».

. - .:

« ».-2008.-

52. . 66 - 77. 2.

. .

//

:

.

. -

:

,

. 36. 2008. -

. 94 - 101. 3.

. .,

. .

//

«

»

«

».-

,

2. 2009 - .74-83. 4.

. .

20.05.2010 .

QUALITY IMPROVEMENT FOR LARGE-SIZED PRODUCTS TO BE RECONDITIONED

Abstract: Selected class of large-sized products of a rotation body shape subject to reconditioning after worked-out resources of working face requires development of activities to ensure products quality during their re-use. Resulting from tolerances analyses for cylindrical surfaces radial sizes of products' tail pieces components to be reconditioned, the optimum alternative tolerance bands have been adjusted and specified during design stage for newly produced products that ensures diametrical sizes conformity with technical documentation data during their subsequent reconditioning.

Key words: heavy engineering, large-sized products reconditioning, tolerance bands adjustment